



**Massachusetts Bay
Transportation Authority**

Newton Stations Accessibility Improvements

Project Update

Angel Donahue-Rodriguez, Assistant General Manager for External Affairs

Sharon Cranston, Project Manager Capital Delivery

April 10, 2024

Overview

English

- Thank you for joining the meeting! We appreciate your participation.
 - This meeting will **be recorded** so that it can be shared with the people that were unable to join.
 - All participants will be muted upon entry so that only the presenters can be heard.

Spanish

- ¡Gracias por atender esta junta! Agradecemos su participación.
 - Esta junta estaría grabada para poder compartir con los que no pudieron asistir.
 - Los participantes están silenciados al entrar la junta para que solo se pueda oír a los presentadores.

Chinese

- 感谢您参与此会议！
 - 本次会议将会**被录像**，以便我们把它分享给没能来参加的人。
 - 所有参与者在进来时都会被静音，以便于演讲者能被听到。



Diversity and Civil Rights

English

- All MBTA activities, including public meetings, are free of discrimination. The MBTA complies with all federal and state civil rights requirements preventing discrimination on the basis of race, color, national origin, limited English proficiency, and additional protected characteristics. We welcome the diversity from across our entire service area. If you have any questions or concerns, please visit www.mbta.com/titlevi to reach the Office of Diversity and Civil Rights.

Spanish

- Todas las actividades de MBTA, incluidas las reuniones públicas, están libres de discriminación. La MBTA cumple con todos los requisitos de derechos civiles federales y estatales que impiden la discriminación por motivos de raza, color, origen nacional, dominio limitado del inglés y características protegidas adicionales. Damos la bienvenida a la diversidad de toda nuestra área de servicio. Si tiene alguna pregunta o preocupación, visite www.mbta.com/titlevi para comunicarse con la Oficina de Diversidad y Derechos Civiles.

Chinese

- MBTA 的所有活动，包括公开会议，都没有歧视。MBTA 遵守所有联邦和州公民权利要求，防止基于种族、肤色、国籍、有限的英语能力和其他受保护特征的歧视。我们欢迎来自我们整个服务领域的多样性。如果您有任何问题或疑虑，请访问 www.mbta.com/titlevi 联系多元化和民权办公室



Closed Captions

- Click **Closed Caption** to start viewing closed captioning
 - **Tip:** Click and drag the closed captioning to move its position in the meeting window.
- To adjust the caption size:
 - Click the upward arrow next to **Start Video / Stop Video**.
 - Click **Video Settings** then **Accessibility**.
 - Move the slider to adjust the caption size

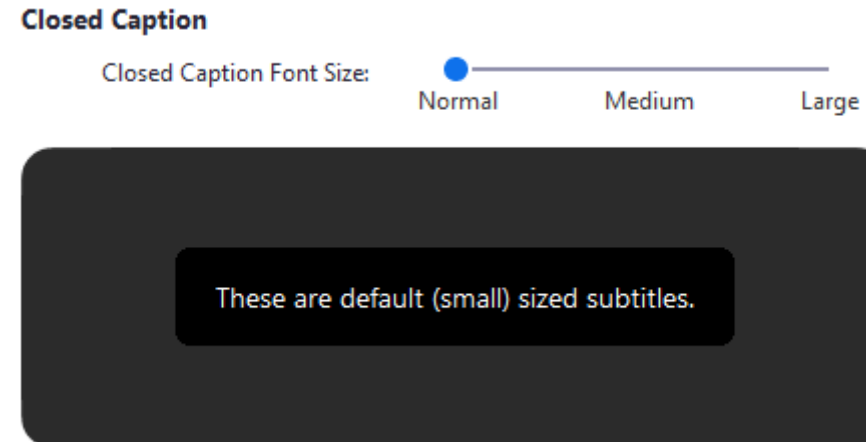
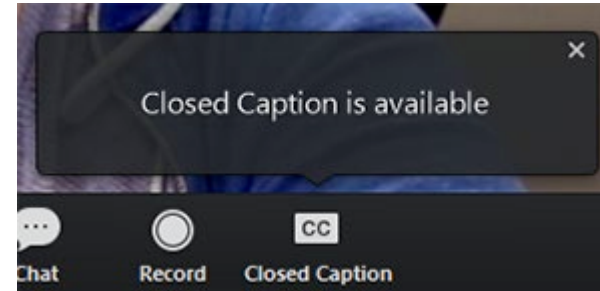

Use Chat for Technical Questions

English

- If you have a technical question about Zoom or the features of the meeting, please use the chat function. Our technical assistant will attempt to troubleshoot your problem and get back to you.

Spanish

- Si tiene una pregunta técnica de zoom o los enseres de zoom durante la junta. Favor de usar el chat. Nuestro asistente técnico bajo el nombre de “Zoom Tech” le ayudará con su problema.

Chinese

- 如果您有关于Zoom或者会议功能的技术问题，请使用对话框的聊天功能。我们的技术辅助员会回复您并尽力帮您解决问题。

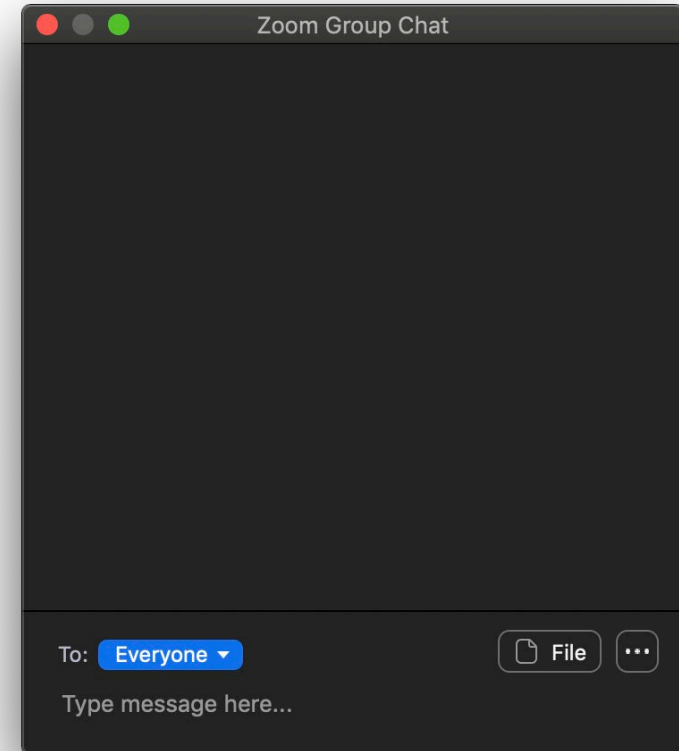

Agenda

- Project Overview
- Existing Conditions
- Project Update
- New Phased Approach
- Newtonville Station Platform Concepts
- Next Steps



Project Overview

- The MBTA's *Newton Commuter Rail Stations Accessibility Improvements Project* consists of providing new, fully-accessible platforms for three existing Worcester Line Stations in Newton: Auburndale, West Newton, and Newtonville.



Existing Conditions

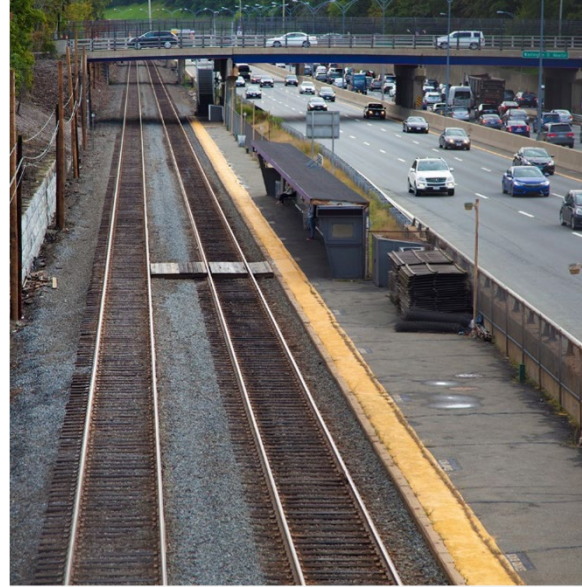
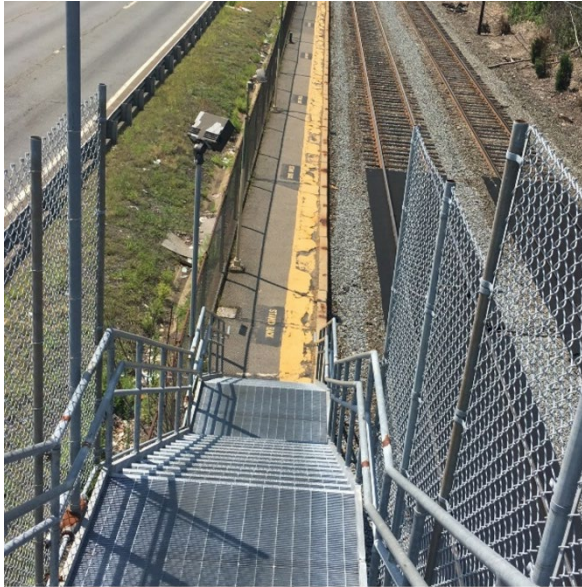

The existing stations are in disrepair and are inaccessible, with low-level platforms that can only be reached via stairways

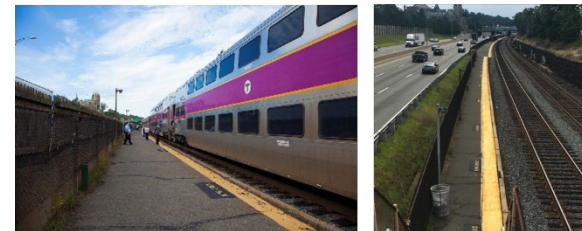
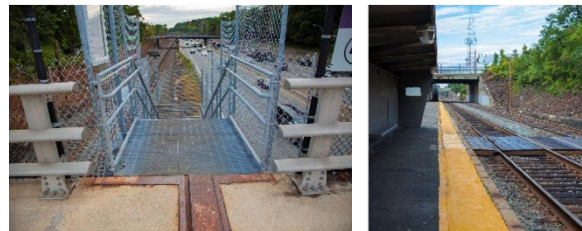
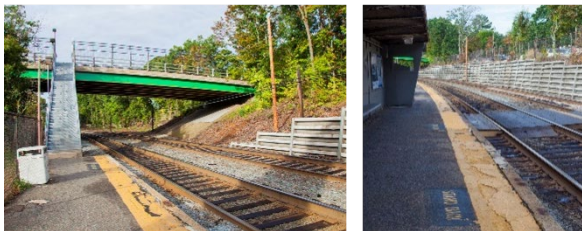

Auburndale

West Newton

Newtonville



Project Update

- The previous concept of 3 stations has an estimated project total cost of \$250M and construction duration of 6 years.
- Since the last project update construction costs have escalated significantly due to inflation, increased labor costs, supply chain challenges, and increased material costs.
- MBTA was unsuccessful in 2022 ASAP grant application to FTA.



New Phased Approach

- Proceed with Newtonville Station at this time.
 - Highest ridership station
 - Greatest Transit Oriented Development opportunities
 - Site has enough space to consider a center island platform without significantly modifying adjacent bridge structures
- Current Proposed Concept: Reduce platform length from 800 ft to 400 ft based on parameters provided by MBTA Operations.
 - Smaller station has reduced labor and material costs
- One fully accessible up-and-over structure to provide access to both platforms.
 - Additional emergency egress into designated area within the rail Right-of-Way



Newtonville Station: 400' Double Side Platforms Concept

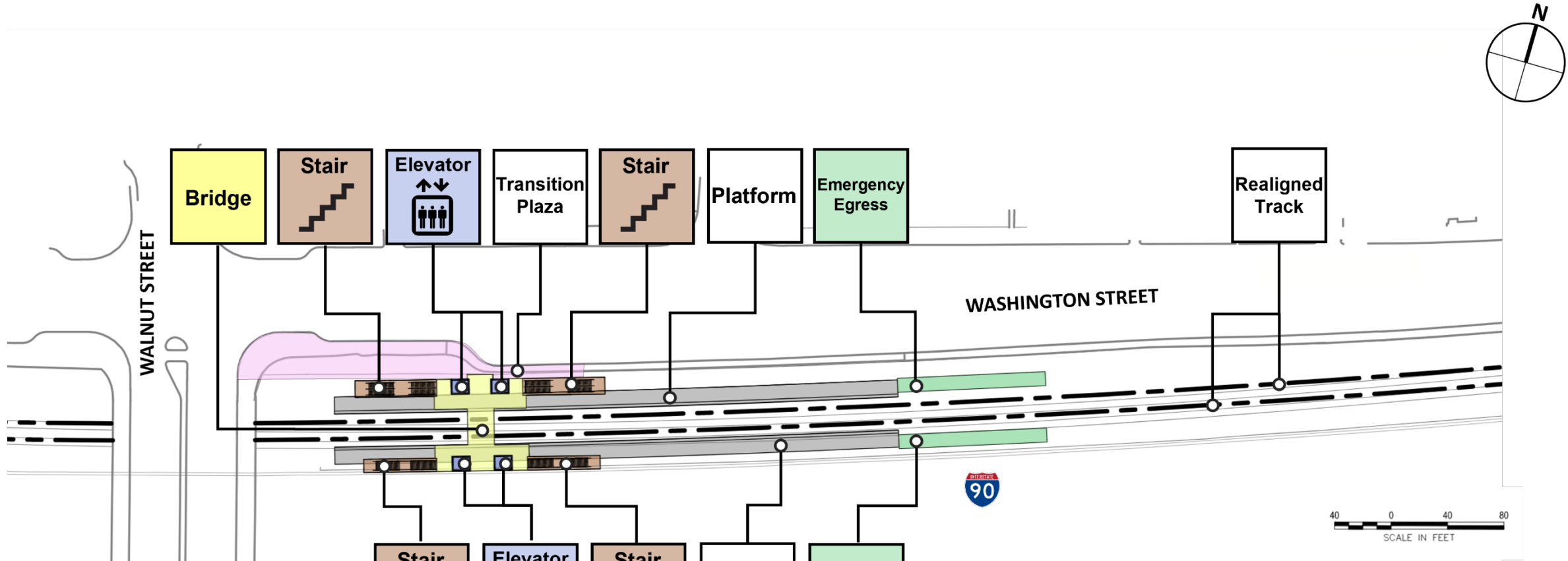

Newtonville Station: 400' Center Island Platform Concept

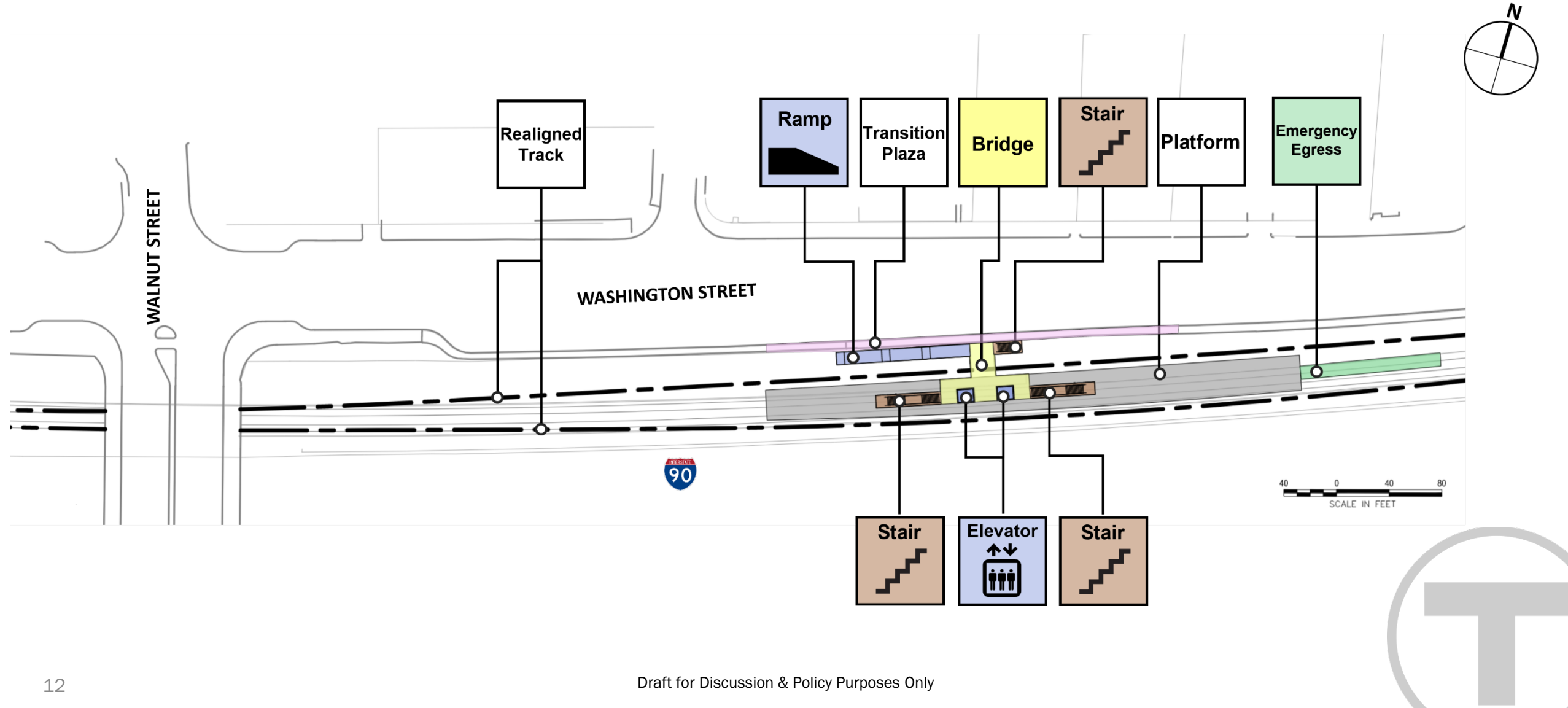

Next Steps

- Continue coordination with Municipal, State, and Federal partners.
- Develop a funding and financing plan and continue to explore new funding opportunities.
 - The Project Team revisited the project scope to re-apply for an ASAP grant in January 2024 for \$40M with a \$10M MBTA match
 - Project team explored various sequencing decisions
- Awaiting outcomes of two FTA funding submissions
- Continue coordination with internal MBTA departments, including MBTA System-wide Accessibility and Rail Modernization.



Raising Your Hand

- Please use Zoom’s “Raise Hand” feature to indicate if you have a comment
 - All participants are muted upon entry so that only the presenters can be heard. Please raise your hand and the meeting host will ask you to unmute so that you can state your question/comment.
- Por favor de usar el encero de levantar la mano en Zoom para indicar que usted tiene algún comentario o pregunta.
 - Todos los participantes en esta llamada están silenciados, para que solo los presentadores se puedan oír. Cuando usted levante su mano, manda un alerta a la moderadora que quisiera hablar. La moderadora le quitará el silencio para que pueda hacer su pregunta o comentario.
- 如果您有评论，请使用 Zoom 的“举手”功能。
 - 所有的参与者在进来时都被静音了以便于只听到演讲者。请举手，会议主持人将让您取消静音，以便您陈述您的问题/评论。



To speak, click
“Raise hand”



Send a chat
to the moderator



***9**
Raise Hand

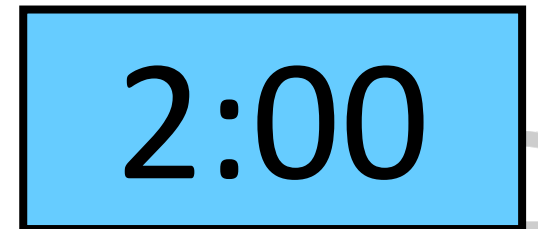

Contact Us

Email: PublicEngagement@mbta.com

Phone: 617-222-3030

Website: mbta.com/NewtonCR

